



LED Surface Mount Light
LED-1140



Product Description:

This newly designed luminaire with built-in heatsink in casting featuring its versatility that can be served as wall light, flood light and etc. Incorporated with high performance LEDs along with high quality optical reflector, this fixture performs efficiently and steadily against harsh outdoor environment .

Optional mounting and Kelvin color* with adder.

Features:

LISTING

UL and CUL listed for wet locations

HOUSING

Solid construction die-cast aluminum body

FINISH

UV stabilized powder coated finish

LENS

High-impact resistant tempered glass

OPTIONS

Optional photo control with adder

Finish - Bronze. Color option with adder

Line Drawing

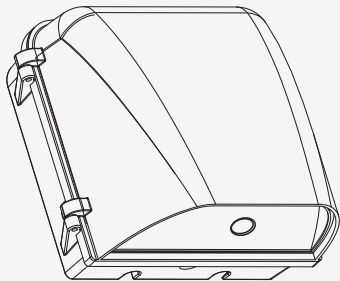

Dimensions

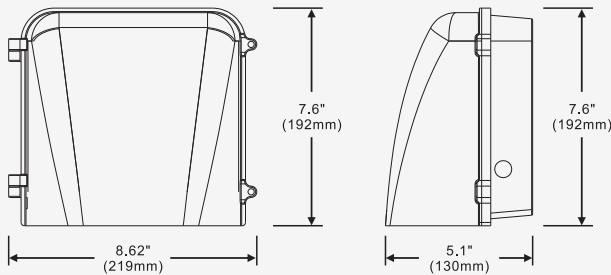

* Different LED Kelvin temperature available with 4-6 week lead time. Please call for a quote.
** DISCLAIMER: This test report was produced in accordance with IES LM-79 photometric testing protocol for luminaires, using a single representative test fixture. Actual production units may vary from the values reported here by up to ±10%.



LED Surface Mount Light
LED-1140

Product Description:

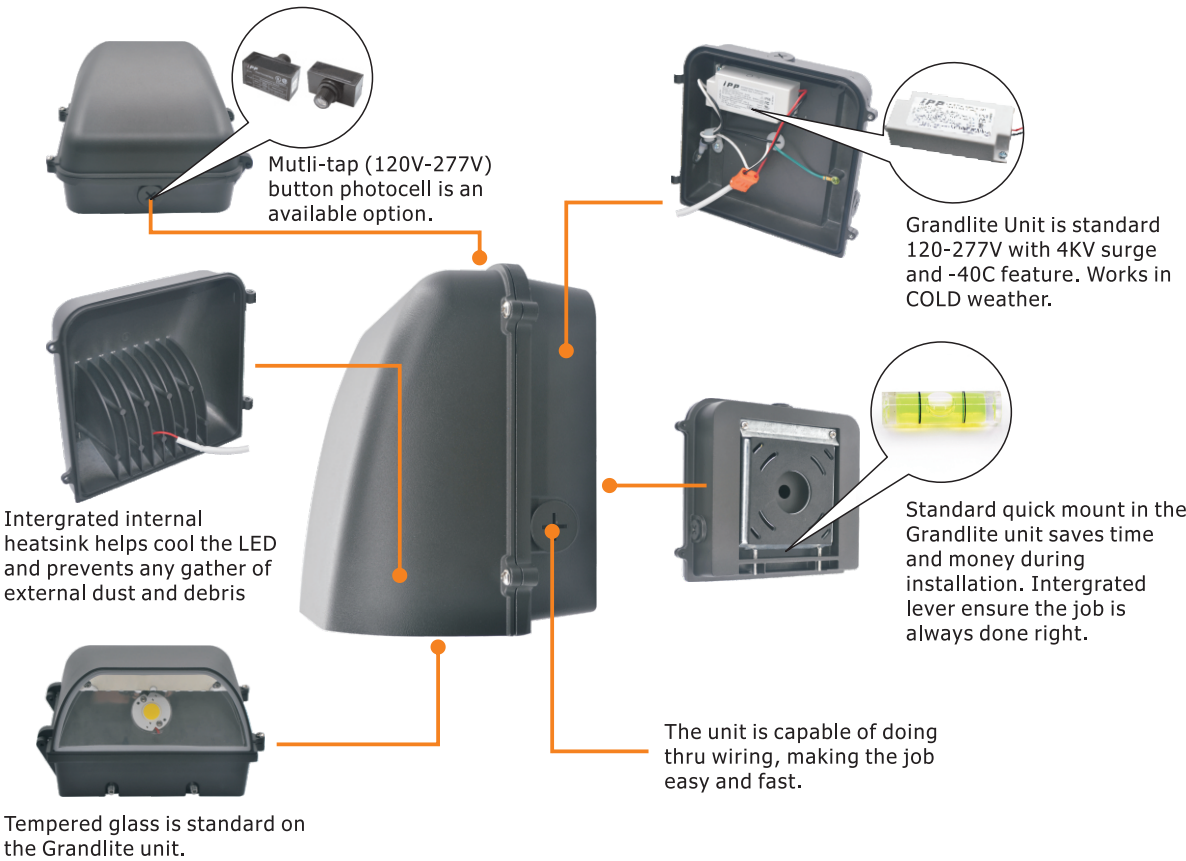

Performance Data

Model NO.	System Watts	Dist. Type	Lumens	Lpw	B	U	G
LED-1140	13 W	Type II	1607 lm**	123 lm/W	2	3	2
	20 W	Type II	2776 lm**	138 lm/W	2	3	2
	28 W	Type II	3482 lm**	124 lm/W	2	3	2

Specification:

Example: LED-1140 013UNV750

Model No.	System Watts	Input Voltage	CRI	Color Temp	Option	Feature	Finish	Starting Temp
LED-1140	013=13W 020=20W 028=28W	UNV=120-277V	7=70+	40=4000 K 50=5000 K	XS= 10kV Surge 2S= 20kV Surge	W =Wall Mount	Bronze	-40°C ~ +50°C

* Different LED Kelvin temperature available with 4-6 week lead time. Please call for a quote.
** DISCLAIMER: This test report was produced in accordance with IES LM-79 photometric testing protocol for luminaires, using a single representative test fixture. Actual production units may vary from the values reported here by up to ±10%.

