



LED Surface Mount Light

SML-304



Product Description:

This half oval full cut-off wall pack is elegant as it is functional. With high performance LEDs and long lasting driver, this fixture provides effective lighting all around. It can be used around factories, restaurants, shopping centers, etc.

Optional mounting and Kelvin color* with adder.

Features:

LISTING

UL and CUL listed for wet locations

HOUSING

Die-cast aluminum body

LEDs

New generation LED

FINISH

UV stabilized power coated finish

OPTIONS

Finish - Bronze. Color option with adder

Available Options



Quick mount

Line Drawing

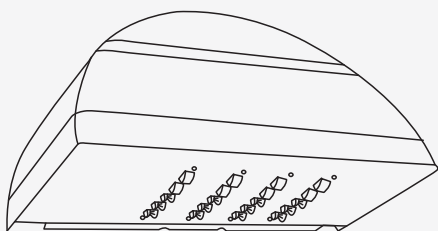

Dimensions

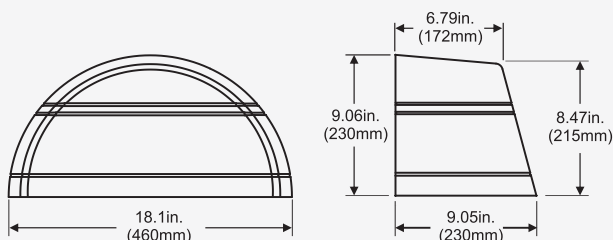

Specification

Model No.	SML-304-L20
System watts	32
Lumen Output	3438 lm**
Color	5000 K
MA	500 MA
Input Voltage	120~277V
CRI	70+
Starting Temp	-40°C
Equivalent	100W-150W MH

* Different LED Kelvin temperature available with 4-6 week lead time. Please call for a quote.

** DISCLAIMER: This test report was produced in accordance with IES LM-79 photometric testing protocol for luminaires, using a single representative test fixture. Actual production units may vary from the values reported here by up to ±10%.