

# Grandlite®

HIGH POWER LIGHTING SYSTEM

## Wall Pack

**LED-3110**



### APPLICATIONS

	Retails & Supermarkets
	Hotels & Restaurants
	Commercial Buildings
	Offices And Showrooms
	Schools & Colleges



2022-06

### Product Description:

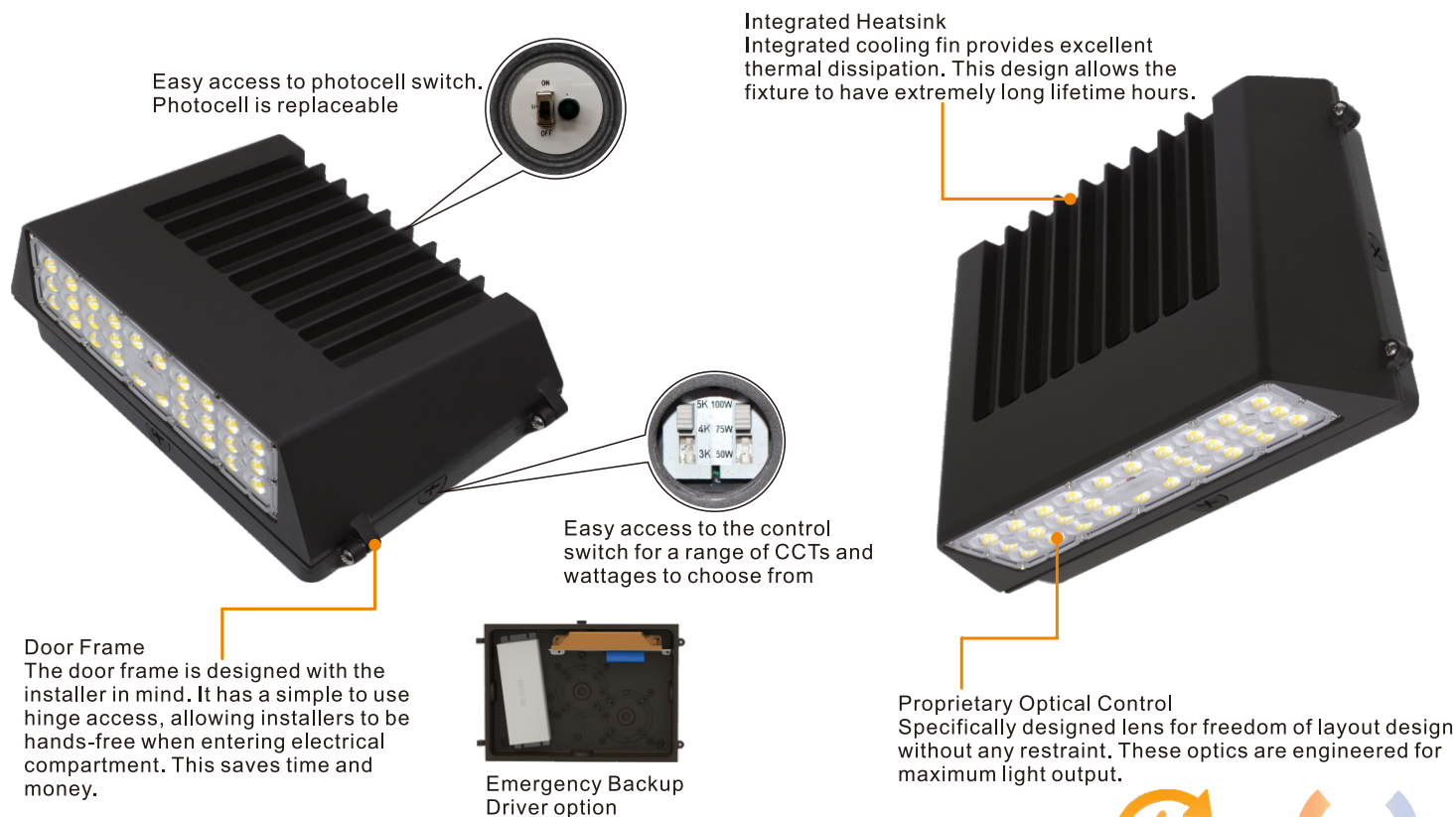

### Product Description:

The LED-3110 is a powerful luminaire that has been designed to meet a wide variety of locations. With the various mounting options it can be used as a flood light or as an area light. With the LEDs mounted on the large heatsink, the fixture can maintain a high lumen output while keeping the LED modules at a cool temperature.

Optional Kelvin color\* with adder.

### Features:

#### LISTING

UL and CUL listed for wet locations

#### HOUSING

Heavy duty die-cast aluminum powder coating, corrosion resistant hardware

#### FINISH

UV stabilized powder coated finish

#### LENS

Heat and impact PC Lens

#### OPTIONS

Wide / narrow distribution available with adder

Finish - Bronze. Color option with adder

### Performance Data

Model NO.	System Watts	Lumens	LPW
LED-3110	20/30/40W	5594 lm**	140 lm/w
LED-3110	25/45/55W	7237 lm**	132 lm/w
Lumen and Efficacy are based on the highest wattage at 5000K			

### Specification:

Example: LED-3110

Model No.	System Watts	Input Voltage	CRI	Color Temp	Distribution	Option	Finish	Starting Temp
						Accessories		
LED-3110	40=40W	UNV=120-277V	7=70+	40=4000 K	T3=Type III	PE=Photocontrol EM=Emergency Driver FAO=FAO Controller	BZ=Bronze	-40°C
LED-3110	55=55W			50=5000 K	T4=Type IV			

\* Different LED Kelvin temperature available with 4-6 week lead time. Please call for a quote.

\*\* DISCLAIMER: This test report was produced in accordance with IES LM-79 photometric testing protocol for luminaires, using a single representative test fixture. Actual production units may vary from the values reported here by up to  $\pm 10\%$ .

### Dimension:

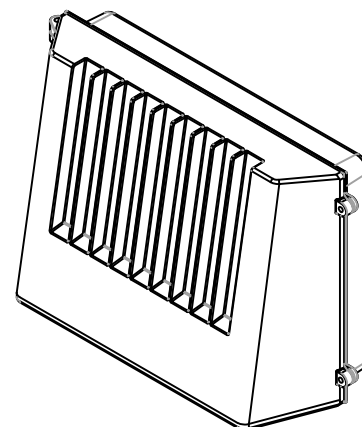
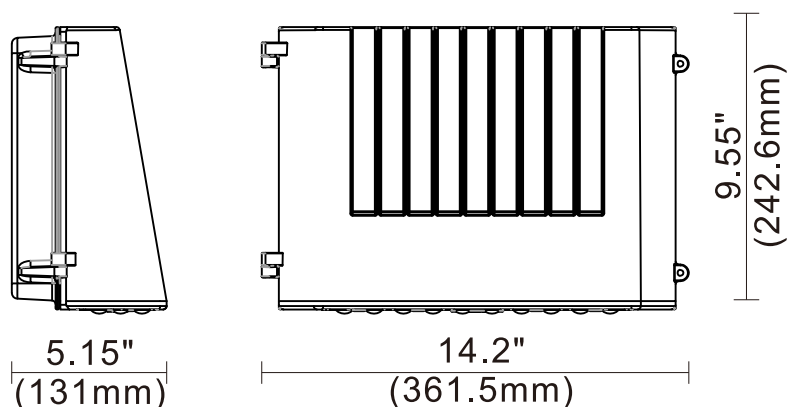



505 S. Yorbita Road, City of Industry, CA 91744, USA

Tel: (626) 839-8868 Fax: (626) 581-8099

e-mail: [sales@grandlite.com](mailto:sales@grandlite.com)



[www.grandliteled.com](http://www.grandliteled.com)