

Grandlite®
HIGH POWER LIGHTING SYSTEM

LED Area Light

LED-6032



Trunnion



Slip Fitter



Pole Mount



2022-07

Product Description:

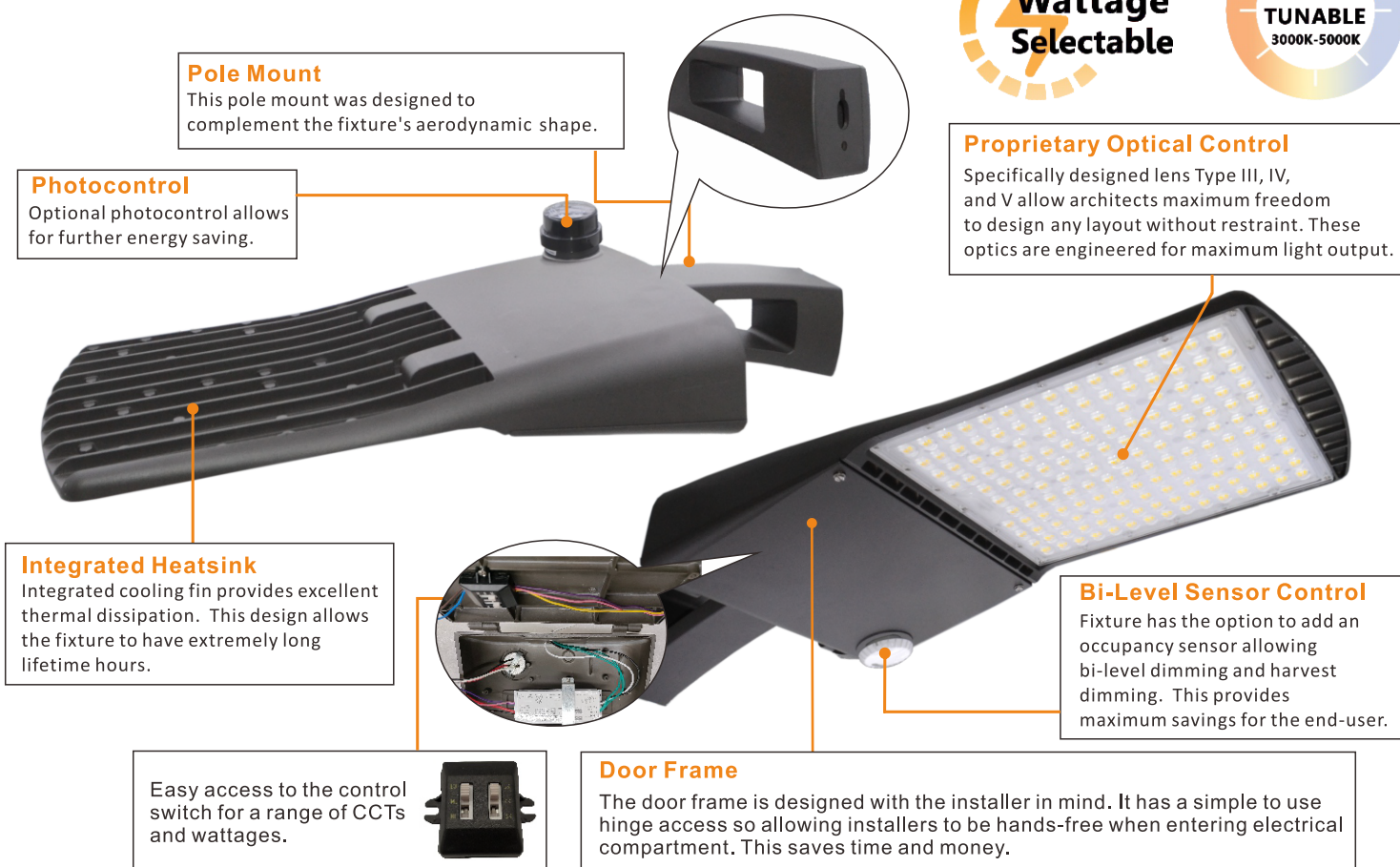

Product Description:

This slick and modern luminaire has been designed to be powered efficiently. With a beautiful slimline design along with one of the highest lumen performance on the market, this versatile fixture can be used as an area light. LED 6032 is ready to conquer the lighting landscape with included mounting options, surge protection devices, IOT photocell capability, and the most technologically advance LED on the market.

Features:

LISTING

- UL and cUL listed

HOUSING

- One piece die-cast aluminum body with die-cast hinge panel for easy installation access.

LEDS

- The most technologically advanced LED chips in the market

FINISH

- UV stabilized powder coated finish

LENS

- Optional Type III, Type IV, Type VS optics

OPTIONS

- Optional 347V or 480V with adder
- Bi-Level Dimmable or Photocontrol optional available with adder
- Finish - Bronze. Color option with adder
- Optional 10KV surge

Performance Data

Model No.	Nominal Watts**	Lumens**	Efficacy**	Input Voltage
LED-6032	290 / 250 / 200W	39470 lm**	136 lm/W	UNV=120-277V HV4=347-480V

** Lumen and Efficacy are based on highest wattage 5000K

Specification:

Example: LED-6032

Model No.	Nominal Watts**	Input Voltage	CRI	Color Temp	Distribution	Option		Finish	Starting Temp
						Accessories	Mounting		
LED-6032	290=290W	UNV=120-277V HV4=347-480V	7=70+	30=4000 K 40=4000 K 50=5000 K	T3=Type III T4=Type IV T5=Type V	XS=10kv Surge OS=Occupancy Sensor PE=Photocontrol 3R=3-pin Receptacle 5R=5-pin Receptacle 7R=7-pin Receptacle	PM=Pole Mount SF=Slip Fitter U=U Bracket	BZ=Bronze	-40°C

Dimension:

LED-6032PM

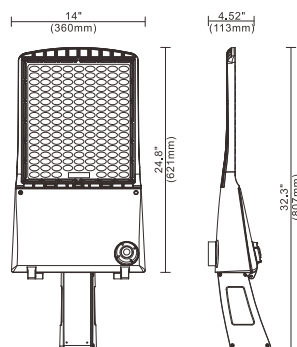

LED-6032SF

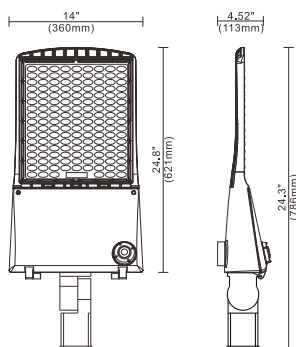

LED-6032TR

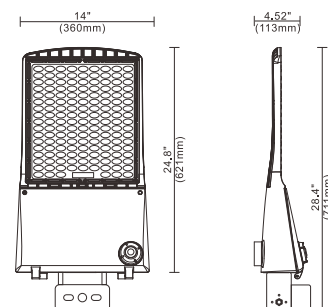

* Different LED Kelvin temperature available with 4-6 week lead time. Please call for a quote.

** DISCLAIMER: This test report was produced in accordance with IES LM-79 photometric testing protocol for luminaires, using a single representative test fixture. Actual production units may vary from the values reported here by up to $\pm 10\%$.



505 S. Yorbita Road, City of Industry, CA 91744, USA

Tel: (626) 839-8868 Fax: (626) 581-8099

e-mail: sales@grandlite.com

www.grandliteled.com